



Transforming Lives®

How to Install a Wireless Entertainment Mount Accessory onto a NuStep® T5 / T5^{XR}

Tools Required

Phillips screwdriver
Sharp point awl or scribe

Accessory Kit Parts

(1) 50672-100 Bracket–Wireless Entertainment Mount (Champagne)
or
(1) 50672-200 Bracket–Wireless Entertainment Mount (Warm Black)
(1) 50732 Washer, Flat #8, Zinc
(1) 50727 Screw - HiLo, #8-18x.75

- 1 Remove two screws on lower cover with screwdriver.

Position fingers on top edge and PRESS DOWN AND PULL OUT to unlock lower cover and remove.



- 2 Locate the recessed dimple between the ribs on the inside of the lower neck cover. Carefully poke a small hole through the cover.



- 3 Position the mount with the holes closest to the edge facing the book rest / up.



- 4 Place washer onto screw and thread screw through hole and into mount. Tighten screw so mount is snug, but DO NOT OVERTIGHTEN as screw can strip in the plastic.

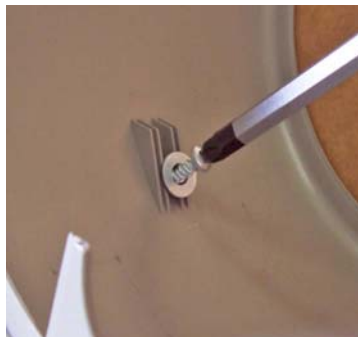



Transforming Lives®

- 5 Replace lower neck cover by inserting lower end into gap between upper neck cover and center trim cover.



- 6 Make sure the tab on each side is positioned directly under each lock. Position fingers and PRESS IN AND UP to lock tabs on both sides into locks. It is a tight fit, and if not secure, repeat step.

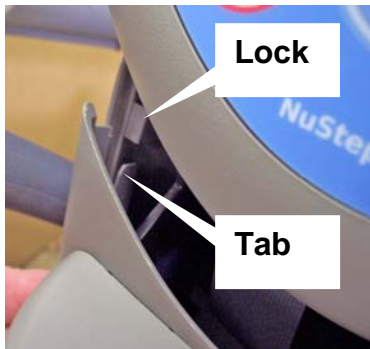

- 7 Refasten lower neck cover using same screws but DO NOT OVERTIGHTEN as they can strip in the plastic.



How to Install a Wireless Entertainment Device on a NuStep® T5 / T5^{XR}

- 1 Route cable ties from underneath and attach wireless device to mount. Snug ties and cut off ends.
- 2 Route cord between grab handle and T5 console and plug into back. Turn on T5 to power up wireless device. Check operation.

